

Road Hubs

Model#	F/R	Hole Count	Gauge	O.L.D.	Axle Length	Q.R.	Weight
RB-68	F	16/20/24	14	100mm	108mm	QR-66	72g
RB-210	R	20/24/28	14	130mm	140mm	QR-66	234g
RB-240	R	20/24/28	14	130mm	140mm	QR-66	240g

-RB-210/240 S10 - C9/10 interchangeable.

Model#	F/R	Hole Count	Gauge	O.L.D.	Axle Length	Q.R.	Weight
RB-91	F	20/24/32/36	14	100mm	108mm	QR-38	100g
RB-35	R	24/28/32/36	14	130mm	140mm	QR-38	328g
RB-325	R	24/28/32/36	14	130mm	140mm	QR-33	384g
RB-3510	R	24/28/32/36	14	130mm	140mm	QR-38	332g

-RB-91 Alloy axle
 -RB-35 Shimano 8/9 speed/Campagnolo freehub body changeable
 -RB-325 Shimano 8/9 speed
 -RB-3510 Shimano 10 speed

Model#	F/R	Hole Count	Gauge	O.L.D.	Axle Length	Q.R.	Weight
RB-51	F	24/32/36	14	100mm	108mm	QR-30	152g
RB-52	R	28/32/36	14	130mm	140mm	QR-30	378g

-RB-52 Shimano 8/9 speed

Model#	F/R	Hole Count	Gauge	O.L.D.	Axle Length	Q.R.	Weight
RB-31	F	32/36	14	100mm	108mm	QR-11	156g
RB-32	R	32/36	14	130mm	140mm	QR-11	388g
RB-32C	R	32/36	14	130mm	140mm	QR-22	456g

-RB-32 Shimano 8/9 speed
 -RB-32C Campagnolo 9/10 speed

Model#	F/R	Hole Count	Gauge	O.L.D.	Axle Length	Q.R.	Weight
RB-21	F	32/36	14	100mm	108mm	QR-22	158g
RB-22	R	32/36	14	130mm	140mm	QR-22	392g

-RB-22 Shimano 8/9 speed
 -135/145mm Available



Front hub for Road

A axle length 108mm
 B over locknut dimensions 100mm
 C flange width 72mm
 D spoke hole PCD 38/45mm
 E axle outer diameter 8.8mm
 F flange diameter 47/54mm

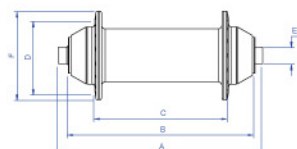

4

Freehub for road bike

A axle length 140mm
 B over locknut dimensions 130mm
 C flange width 57mm
 D D-dimension Shimano (8/9 sp.): 40.5
 Campagnolo (9/10 sp.): 42.5
 E spoke hole PCD 45mm
 F flange diameter 54mm
 G axle outer diameter M10

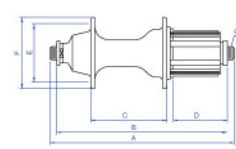

Track Hubs

Model#	F/R	Hole Count	Gauge	O.L.D.	Axle Length	Axle Dia.	Flange Width	Weight
TH-20	F	32/36	14	100mm	140mm	M9	47mm	212g
TH-21	R	32/36	14	120mm	160mm	M10	54mm	290g
TH-22	R	32/36	14	120mm	160mm	M10	54mm	286g

-TH-21 Flip-flop, thread:R=BC1.37, L=BC1.29/1.37 (Single speed freewheel / fixed gear)
 -TH-22 Flip-flop, thread:R/L=BC1.29/1.37 (Fixed gear both side)

Model#	F/R	Hole Count	Gauge	O.L.D.	Axle Length	Axle Dia.	Flange Width	Weight
TH-50	F	32/36	14	100mm	140mm	M9	71.5mm	272g
TH-51	R	32/36	14	120mm	160mm	M10	71.5mm	324g
TH-52	R	32/36	14	120mm	160mm	M10	71.5mm	322g

-TH-51 Flip-flop, thread:R=BC1.37, L=BC1.29/1.37 (Single speed freewheel / fixed gear)
 -TH-52 Flip-flop, thread:R/L=BC1.29/1.37 (Fixed gear both side)

Model#	F/R	Hole Count	Gauge	O.L.D.	Axle Length	Axle Dia.	Flange Width	Weight
TH-30	F	32/36	14	100mm	140mm	M9	71.5mm	272g
TH-31	R	32/36	14	120mm	160mm	M10	71.5mm	324g
TH-32	R	32/36	14	120mm	160mm	M10	71.5mm	322g

-TH-31 Flip-flop, thread:R=BC1.37, L=BC1.29/1.37 (Single speed freewheel / fixed gear)
 -TH-32 Flip-flop, thread:R/L=BC1.29/1.37 (Fixed gear both side)

Model#	Dimension	Cog Finish	Lock Ring	Material
SKU-1	1/8" x 15T	UCP	ATN-069B	Alloy Black
	1/8" x 18T	UCP		
SKU-2	1/8" x 16T	BK	ATN-069A	Steel Black



Model#	F/R	Hole Count	Gauge	O.L.D.	Axle Length	Q.R.	Weight
OV-91	F	24/32/36	14	100mm	108mm	QR-33	130g
OV-32S	R	24/28/32/36	14	135mm	145mm	QR-33	402g



Model#	F/R	Hole Count	Gauge	O.L.D.	Axle Length	Q.R.	Weight
OV-31	F	32/36	14	100mm	108mm	QR-11	160g
OV-32	R	32/36	14	135mm	145mm	QR-11	418g



Model#	F/R	Hole Count	Gauge	O.L.D.	Axle Length	Q.R.	Weight
FM21-FQR	F	32/36	14	100mm	108mm	QR-11	154g
FM31-RQR	R	32/36	14	135mm	145mm	QR-11	258g
FM32-8QR	R	32/36	14	135mm	145mm	QR-11	404g



-FM32-8QR 7 speed available

Model#	F/R	Hole Count	Gauge	O.L.D.	Axle Length	Q.R.	Weight
DC-94	F	24/32/36	14	100mm	108mm	QR-61	154g
DC-38	R	24/32/36	14	135mm	145mm	QR-61	380g
DC-58	R	24/32/36	14	135mm	145mm	QR-61	398g

-DC-38 Cromoly axle. Ti axle available

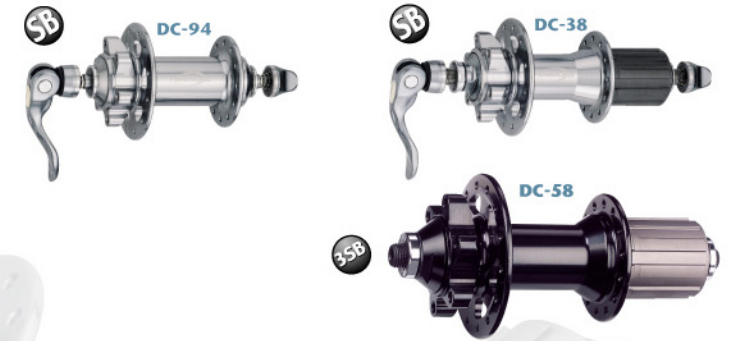

Model#	F/R	Hole Count	Gauge	O.L.D.	Axle Length	Q.R.	Weight
DC-91	F	24/28/32/36	14	100mm	189mm	QR-45	220g
DC-32	R	24/28/32/36	14	135mm	420mm	QR-45	464g



Model#	F/R	Hole Count	Gauge	O.L.D.	Axle Length	Q.R.	Weight
DC-20	F	24/32/36	14	100mm	108mm	QR-22	274g
DC-22	R	24/28/32/36	14	135mm	145mm	QR-22	486g



Model#	F/R	Hole Count	Gauge	O.L.D.	Axle Length	Q.R.	Weight
DC-20 LW	F	24/32/36	14	100mm	108mm	QR-22	229g
DC-22 LW	R	24/28/32/36	14	135mm	145mm	QR-22	446g



Front hub for MTB
 A axle length 108mm
 B over locknut dimensions 100mm
 C flange width 72mm
 D spoke hole PCD 38/45mm
 E axle outer diameter 8mm
 F flange diameter 47.54mm

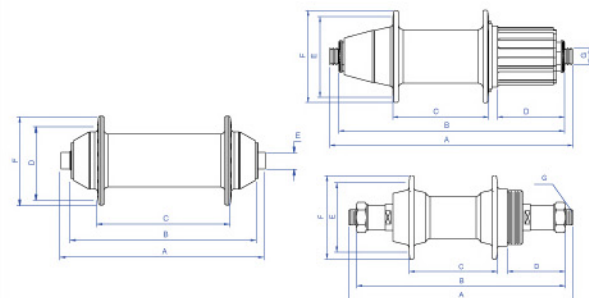

Cassette rear hub for MTB

A axle length 145mm
 B over locknut dimensions 135mm
 C flange width 57mm
 D D-dimension 49.5 (8.9 speed)
 E spoke hole PCD 45mm
 F flange diameter 54mm
 G axle outer diameter M10

Thread on type

A axle length 140 (road)/145 (ATB)
 B over locknut dimensions 130 (road)/135 (ATB)
 C flange width 57mm
 D D-dimension 39/40.5/41mm
 E spoke hole PCD 45mm
 F flange diameter 54mm
 G axle outer diameter M10

Front hub for disc brake

A axle length 108mm
 B over locknut dimensions 100mm
 C disc stop 10.5mm
 D clipper stop 15.5mm
 E flange length 58mm
 F disc inner diameter 33mm
 G thread hole BCD 44mm
 H spoke hole PCD 38mm
 I flange diameter 68mm
 J spoke hole PCD 45.58mm
 K flange diameter 54.68mm

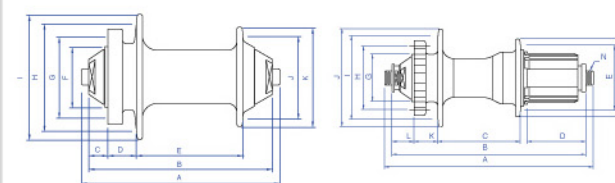

Rear hub for disc brake

A axle length 145mm
 B over locknut dimensions 135mm
 C flange width 57.5mm
 D D-dimension 40.5mm
 E spoke hole PCD 45.58mm
 F flange diameter 54.68mm
 G disc inner diameter 33mm
 H thread hole BCD 44mm
 I spoke hole PCD 38mm
 J flange diameter 68mm
 K clipper stop 15.5mm
 L disc stop 15.25mm
 N axle outer diameter M10

MTB Disc Hubs

Model#	F/R	Hole Count	Gauge	O.L.D.	Axle Length	Q.R.	Weight
DC-140	F	20/24/28/32	14	100mm	108mm	QR-50	138g
DC-260	R	24/28/32/36	14	135mm	135mm	QR-50	260g



Model#	F/R	Hole Count	Gauge	O.L.D.	Axle Length	Q.R.	Weight
DC71	F	32/36	14	100mm	M15	n/a	216g
DC51	F	32/36	14	100mm	M15	n/a	309g



DC71 5mm and 15mm end cap changeable

Model#	F/R	Hole Count	Gauge	O.L.D.	Axle Length	Q.R.	Weight
SG135	R	32/36	14	135mm	145mm	QR-30	372g



Model#	Dimension	Cog Finish	Lock Ring	Material
SKU-3	3/32" x 15T 3/32" x 16T 3/32" x 17T 3/32" x 18T	CP	ATN-081/080	Alloy Black



- Unique adjustable chainline using included 2mm + 5mm spacers.
- Cogs available in multiple sizes to suit all your needs: 13T, 14T, 16T, 18T
- 6 Bolt International disc brake mount
- Optimized wide flange design for the ultimate in complete wheel stiffness.
- Available with QR or nutted axle designs
- Matching style large flange front hub is available.

Cog Size : 3mm or 2.3mm

MTB Single Speed

DC-52 Single Speed MTN Disc Hub

shell material	aluminum
axle material	cromoly
axle diameter	10mm
axle length	145mm
flange distance	71.1mm (left 36.5mm / right 55.5mm)
pitch circle diameter	58mm
spoke hole diameter	14g
freewheel	cromoly
bearings	two bearing system
over locknut diameter	135mm
brake interface	international 6 bolt
available color	black or silver
available number of holes	28/32/36
quick release	QR45
spare parts	cog 1pc & lockring
weight without quick release	472g



DC-52-N

shell material	aluminum
axle material	cromoly solid axle
axle diameter	10mm
axle length	180mm
flange distance	71.1mm (left 36.5mm / right 55.5mm)
pitch circle diameter	58mm
spoke hole diameter	14g
freewheel	steel
bearings	two bearing system
over locknut diameter	135mm
brake interface	international 6 bolt
available color	black or silver
available number of holes	28/32/36

Single Speed MTN Disc Hub

shell material	aluminum
axle material	cromoly solid axle
axle diameter	10mm
axle length	180mm
flange distance	71.1mm (left 36.5mm / right 55.5mm)
pitch circle diameter	58mm
spoke hole diameter	14g
freewheel	steel
bearings	two bearing system
over locknut diameter	135mm
brake interface	international 6 bolt
available color	black or silver
available number of holes	28/32/36
spare parts	with fixing nuts cog 1pc & lockring
weight	514g



Model#	F/R	Hole Count	Gauge	O.L.D.	Axle Length	Q.R.	Weight
DHL91	F	28/32/36	14	110mm	110mm	TA-1270	174g

-DHL91 5mm and 20mm end cap changeable



Model#	F/R	Hole Count	Gauge	O.L.D.	Axle Length	Q.R.	Weight
DHL135	R	32/36	14	135mm	12mm	N/A	372g
DHL150	R	32/36	14	150mm	12mm	N/A	410g



Model#	F/R	Hole Count	Gauge	O.L.D.	Axle Length	Q.R.	Weight
XDH32	R	32/36	14	135mm	10mm	N/A	520g



Model#	Feature
TA20	20mm thru axle
TA12	12mm thru axle
TA10	10mm thru axle



QR22 QR22-F 58g QR22-R 62g	QR23 QR23-F 67g QR23-R 71g	QR30 QR30-F 57g QR30-R 62g	QR31 QR31-F 54g QR31-R 59g	QR33 QR33-F 53g QR33-R 58g
---	---	---	---	---



QR38 QR38-F 54g QR38-R 60g	QR45 QR45-F 60g QR45-R 64g	QR50 QR50-F 58g QR50-R 62g QR50-ST 48g	QR55 QR55-F 56g QR55-R 60g QR55-ST 46g
---	---	--	--



QR61 QR61-F 59g QR61-R 63g	QR66 QR66-F 52g QR66-R 55g	QR68 QR68-F 63g QR68-R 67g
---	---	---

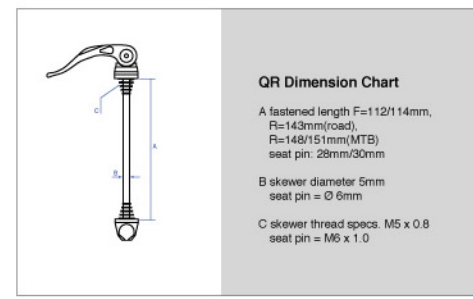

The most bombproof BMX hubs we've ever made.

- Available cogs: 13T, 14T, 16T, 18T
- Precision Sealed bearing design - BX-3210 + BX-3214
- Durable Cup & Cone design - BX-2210 + BX-2214
- Easily serviceable, maintenance friendly design.



BX-3214



BX-2214

BX-3214

shell material
axle material
axle diameter
axle length
flange distance
pitch circle diameter
spoke hole diameter
freewheel
bearings
over locknut diameter
available color
available number of holes

spare parts
weight

aluminum
chromoly solid axle
14mm
165mm
60.6mm(left 32.6mm / right 28.0mm)
54mm
14g
steel
two bearing system
110mm
black or silver
32/36/48
with fixing nuts
cog 1pc & lockring
520g

BX-2214

aluminum
steel solid axle
14mm
165mm
60.6mm(left 32.6mm / right 28.0mm)
54mm
14g
steel
loose ball system
110mm
black or silver
32/36/48
with fixing nuts
cog 1pc & lockring
621g

BMX Cassette Hubs

Model#	F/R	Hole Count	Gauge	O.L.D.	Axle Length	Flange Width	Axle Dia.	P.C.D.	Weight
BX-2214	R	32/36/48	14	110mm	165mm	63.5mm	M14	54mm	578g
BX-2214PC	R	32/36/48	14	110mm	165mm	63.5mm	M14	54mm	592g
BX-3814	R	32/36/48	14	110mm	165mm	63.5mm	M15	54mm	537g
LSD-2214	R	32/36/48	14	110mm	165mm	63.5mm	M14	54mm	580g

-Sprocket 12T-18T available
-BX-2214PC thread BCL37
-BX-3814 tooth drive / 9 - 12T option
-LSD-2214 Left side driving



BX-2214



BX-2214PC



BX-3814



LSD-2214

Model#	F/R	Hole Count	Gauge	O.L.D.	Axle Length	Flange Width	Axle Dia.	P.C.D.	Weight
BR-40	F	32/36	14	100mm	150mm	47mm	3/8"	38mm	258g
BR-41	F	32/36	14	100mm	150mm	54mm	3/8"	45mm	286g
BR-42	R	32/36	14	110mm	170mm	54mm	3/8"	45mm	352g

-BR-42 Thread: BCL37



BR-40



BR-41



BR-42

Model#	F/R	Hole Count	Gauge	O.L.D.	Axle Length	Flange Width	Axle Dia.	P.C.D.	Weight
BR-20	F	32/36	14	100mm	140mm	47mm	3/8"	38mm	222g
BR-21	F	32/36	14	100mm	140mm	54mm	3/8"	45mm	246g
BR-22	R	32/36	14	110mm	160mm	54mm	3/8"	45mm	288g

-BR-22 Thread: BCL37



BR-20



BR-21



BR-22



FORMULA



FORMULA

Front hub for BMX
A axle length 165mm
B over locknut dimensions 100mm
C flange length 72mm
D spoke hole PCD 62mm
E axle outer diameter M14
F flange diameter 71.5mm

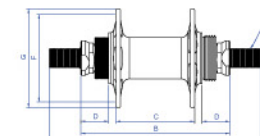
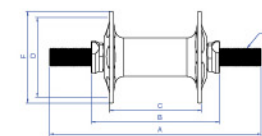

Rear hub for BMX flip-flop
A axle length 175mm
B over locknut dimensions 110mm
C flange width 57mm
D D-dimension 21mm
E axle outer diameter M14
F spoke hole PCD 62mm
G flange diameter 71.5mm

BMX Freestyle

Model#	F/R	Hole Count	Gauge	O.L.D.	Axle Length	Flange Width	Axle Dia.	P.C.D.	Weight
DX-41	F	36/48	14	100mm	150mm	63.5mm	M14	54mm	386g
DX-42	R	36/48	14	110mm	170mm	63.5mm	M14	54mm	398g
DX-43	R	36/48	14	110mm	170mm	63.5mm	M14	54mm	414g
DX-45	R	36/48	14	110mm	170mm	63.5mm	M14	54mm	392g
DX-46	R	36/48	14	110mm	170mm	63.5mm	M14	54mm	402g

-DX-42 Flip Flop, thread: L:M30, R:BC 1.37
 -DX-43 thread: R:BC 1.37
 -DX-45 Flip Flop, thread: L:M30, R:M30
 -DX-46 thread: M30

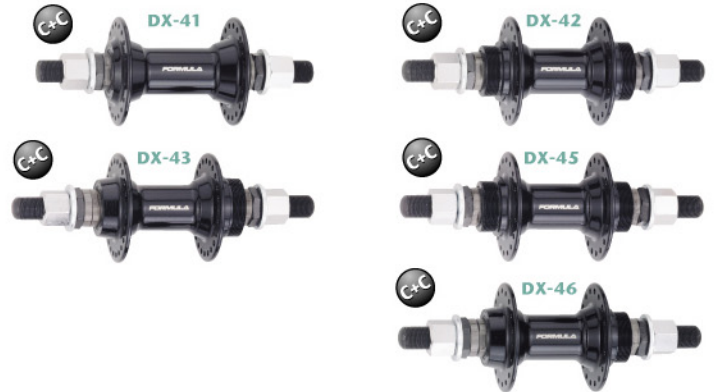

Model#	F/R	Hole Count	Gauge	O.L.D.	Axle Length	Flange Width	Axle Dia.	P.C.D.	Weight
DX-21	F	36/48	14	100mm	150mm	63.5mm	3/8"	54mm	220g
DX-22	R	36/48	14	110mm	170mm	63.5mm	3/8"	54mm	286g
DX-23	R	36/48	14	110mm	170mm	63.5mm	3/8"	54mm	278g

-DX-22 thread: BC 1.37
 -DX-23 Flip Flop, thread: L:M30, R:BC 1.37

